

früh

GASTRONOMIE

CONFERENCE FOLDER



SUCCESSFUL MEETINGS

SUCCESSFUL MEETINGS

Our conference rooms

THE FRÜH IS THE PERFECT PLACE FOR YOUR MEETINGS,
CONFERENCES AND SEMINARS.

The modern and bright conference rooms are located in the centre of Cologne, near the main railway station and with direct connections to Cologne-Bonn Airport. The Cologne Exhibition Centre is just a few minutes walk away.

Apart from its central location, FRÜH Gastronomie is most of all distinguished by many years of experience, a professional implementation, and outstanding services for guests.

We can organize conferences for up to 150 people in seven rooms of various sizes.

- Tagungsraum 1+2 (Conference room 1+2)
- Kölner Raum (Cologne room)
- Kaminraum (Fireplace room)
- Roncalli
- Heintzelmännchen
- FRÜH Lounge

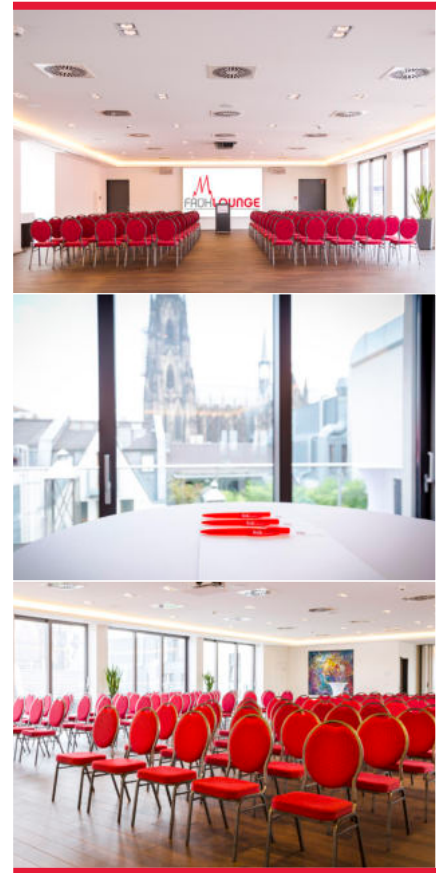

OUR CONFERENCE ROOMS

Tagungsraum 1+2 (Conference room 1+2)

Conference room 1+2 can hold 25 guests each.

They can be joined up by removing a **mobile partition** and then hold up to 45 guests.

Flatscreens are permanently installed in both rooms and can be booked as additional technical equipment. In addition, the meeting rooms are equipped with air conditioning.

The hotel elevator provides **full disabled access**.

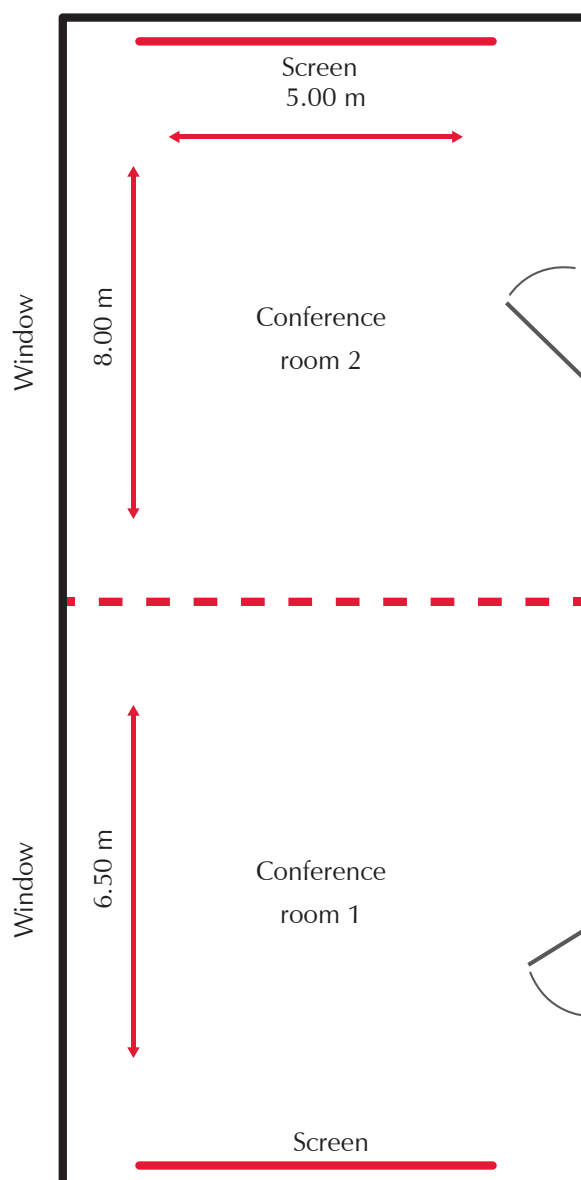

OUR CONFERENCE ROOMS

Roncalli

The absolute highlight of the Roncalli room is the **unique view** of Cologne Cathedral and the "Heinzelmännchenbrunnen" Fountain.

The floor-to-ceiling window facade and wooden floor lend this room a **sophisticated appeal**.

The room offers **full disabled access** and is ideal for 15 - 30 guests, depending on the type of seating.

View of the cathedral

Window facade

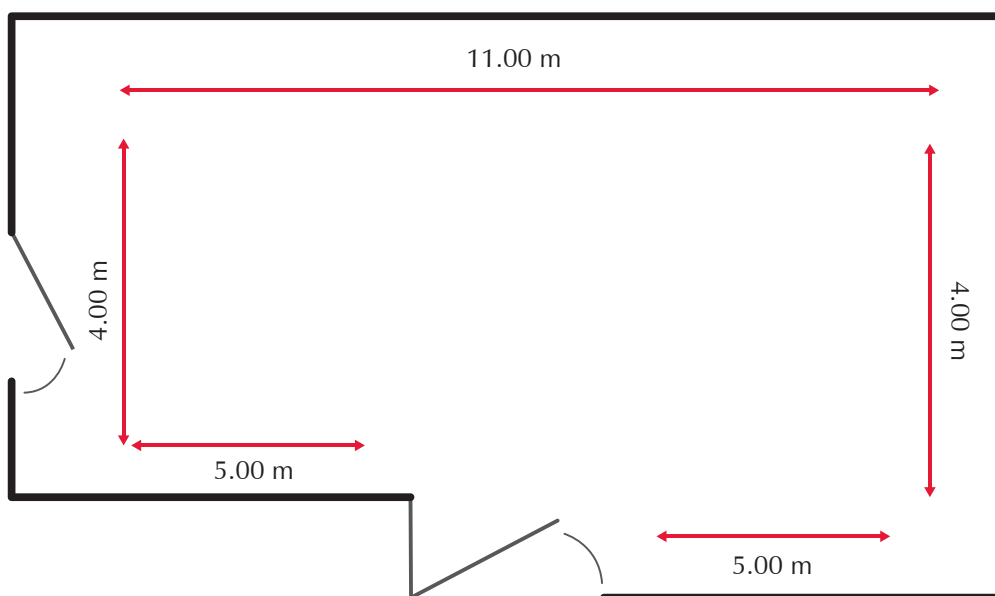

Window

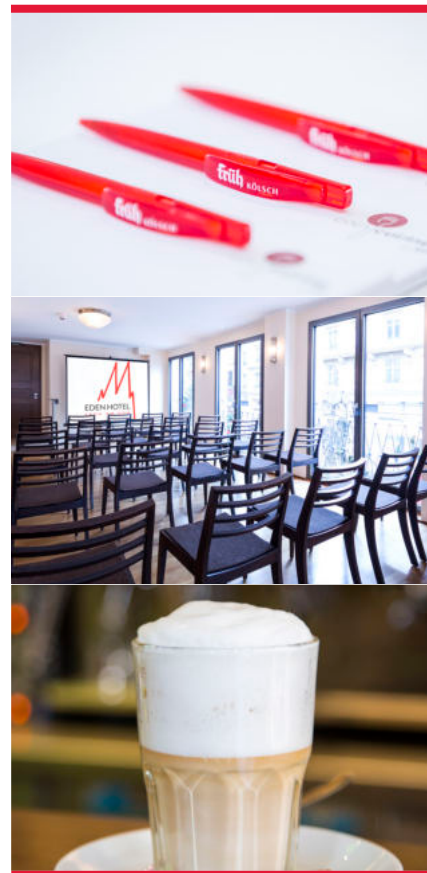

OUR CONFERENCE ROOMS

Heinzelmännchen

Enjoy an **unrivalled view** of the traditional “Heinzelmännchenbrunnen“ Fountain and Cologne Cathedral while holding your conference in the Heinzelmännchen room.

The **stately wooden floor and large window facade** will bring an extraordinary and exquisite atmosphere to your event.

The room measures 90 square meters and can hold up to 50 guests in style seating cinema.



View of the cathedral

Window facade

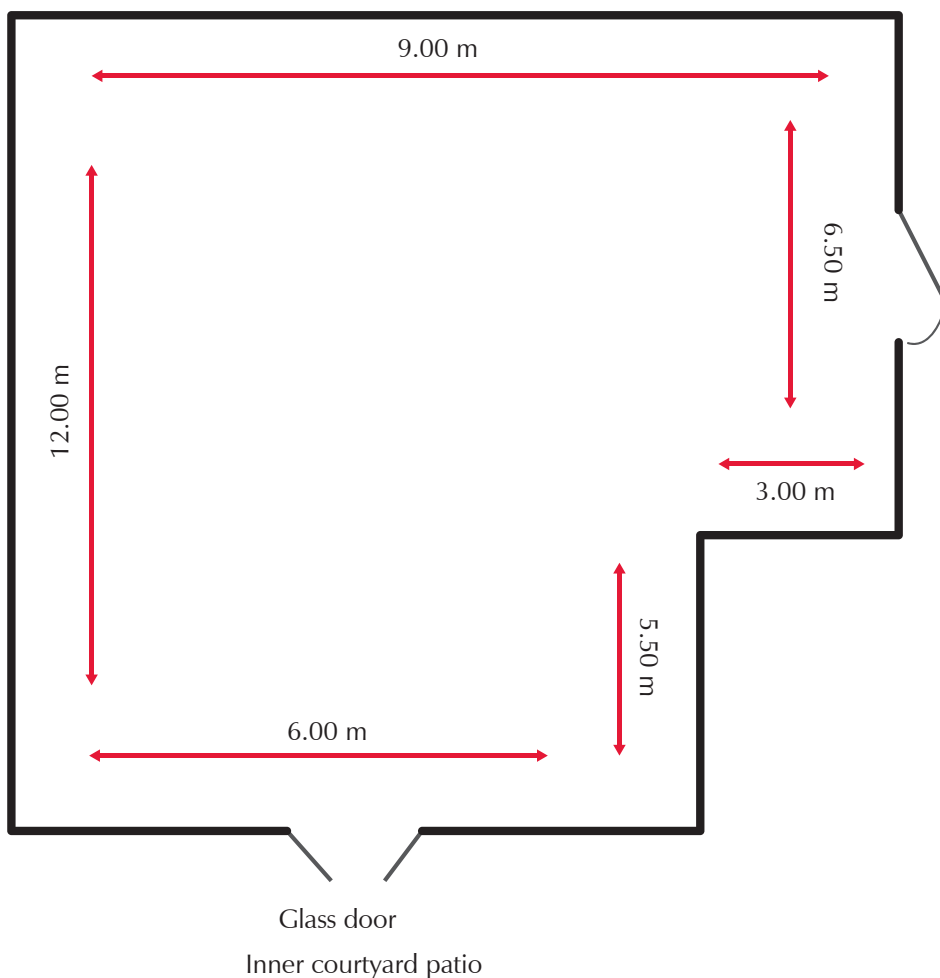

OUR CONFERENCE ROOMS

Kölner Raum & Kaminraum (Cologne Room & Fireplace Room)

The Cologne room can hold up to 30 guests, the Fireplace Lounge up to 35.

They are **on two slightly different levels** and joined by a door with a few steps. Both rooms are on the first floor, above the traditional brewery, and feature floor-to-ceiling windows.

Only the Fireplace room has **full disabled access**.

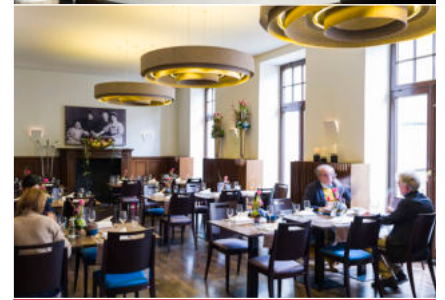
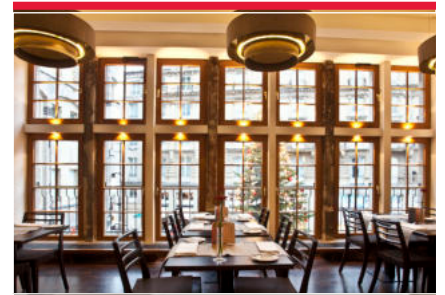
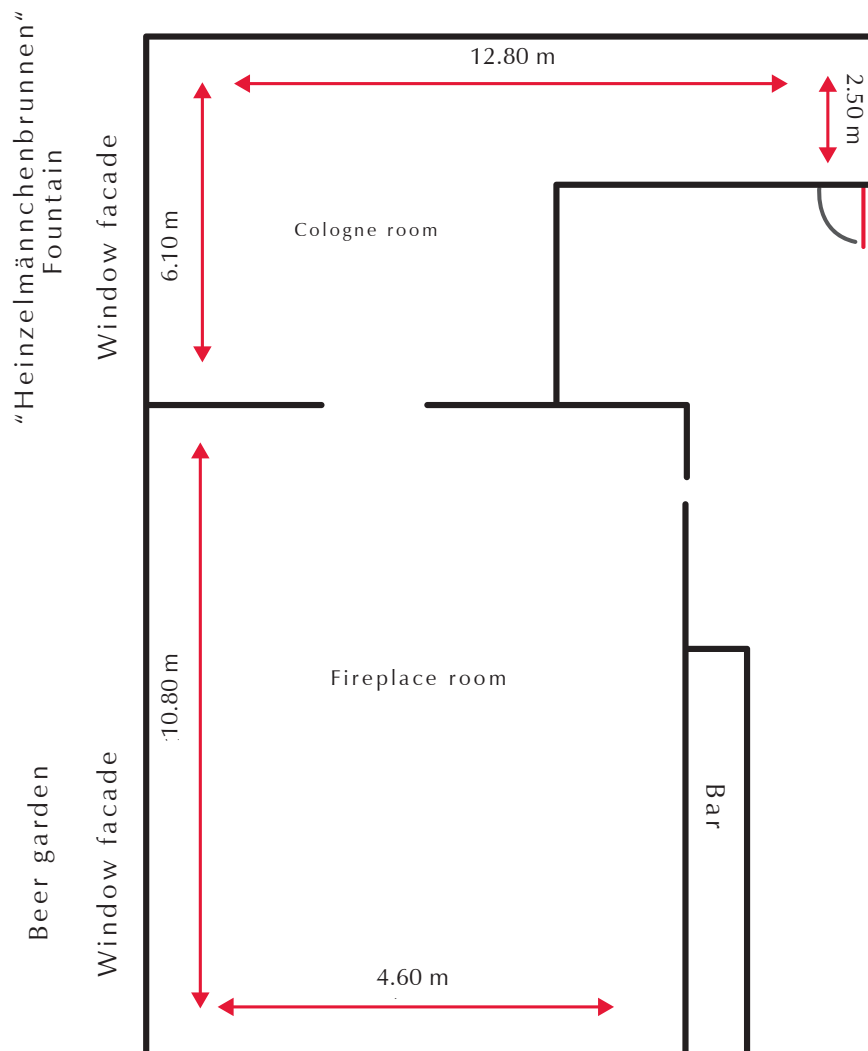

OUR CONFERENCE ROOMS

FRÜH Lounge

The 320 square meter FRÜH Lounge is our largest room for events and can hold **up to 150 conference guests**.

The light-flooded room is located on the 6th floor, looking out **over the roofs of Cologne**, and affords a spectacular view of Cologne Cathedral.

The **large outdoor terrace** is ideal for taking short breaks and getting some fresh air during the conference.

The FRÜH Lounge also has **full disabled access**.

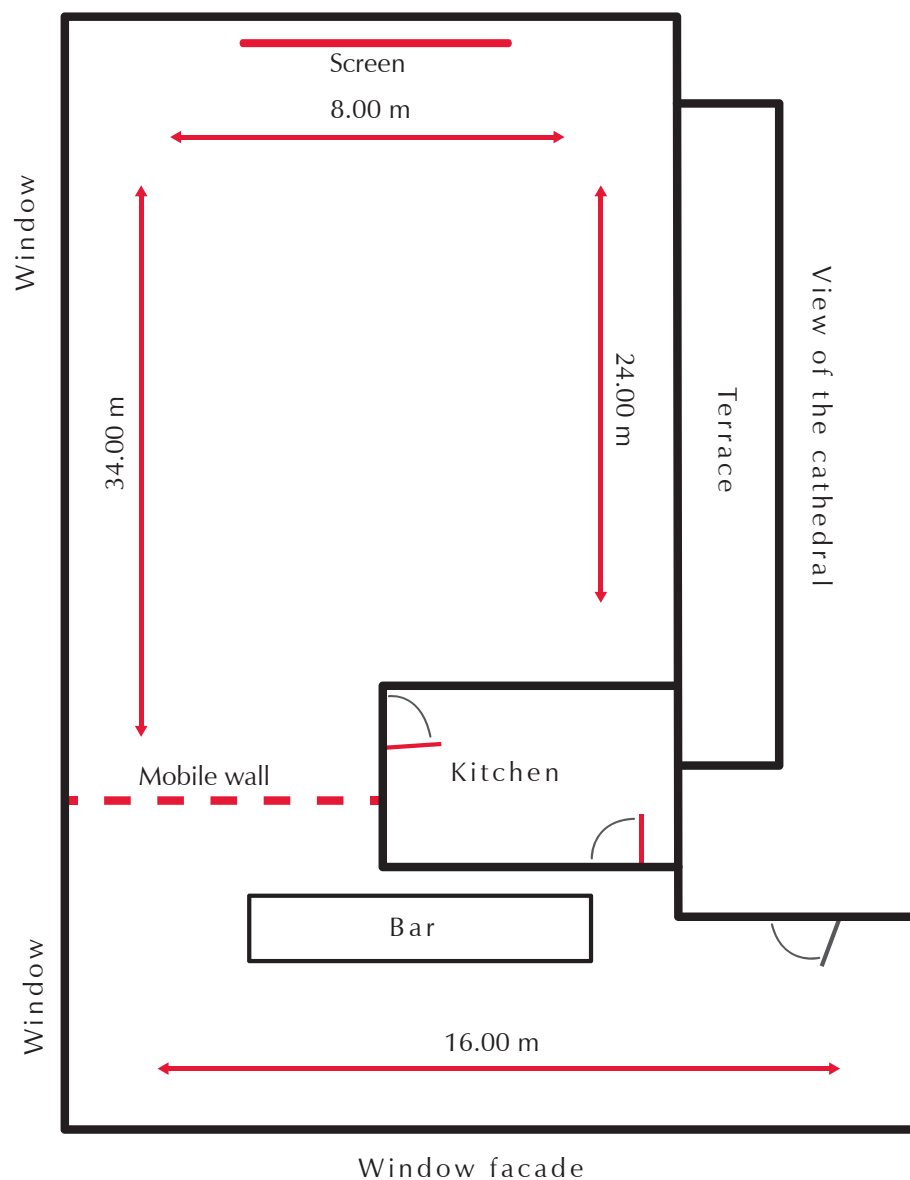
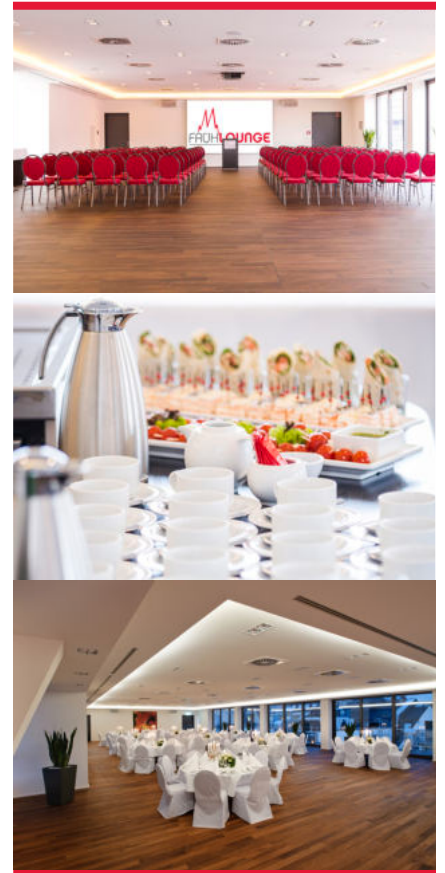

OUR CONFERENCE ROOMS

Room capacities

Find the optimal conference room for your number of guests and seating design:

| Room | Size | U-Shape | Block | Cinema | Parliamentary |
|--|---------|---------|-------|--------|---------------|
| Tagungsraum 1 (Conference room 1) | 40 sqm | 18 | 15 | 25 | 18 |
| Tagungsraum 2 (Conference room 2) | 41 sqm | 18 | 20 | 25 | 18 |
| Tagungsraum 1+2 (Conference room 1+2) | 81 sqm | 35 | 35 | 45 | 36 |
| Heinzelmännchen | 90 sqm | 25 | 25 | 50 | 30 |
| Roncalli | 51 sqm | – | 18 | 30 | 15 |
| Kölner Raum (Cologne room) | 56 sqm | – | 20 | 30 | – |
| Kaminraum (Fireplace room) | 50 sqm | 25 | 25 | 35 | 20 |
| FRÜH Lounge | 320 sqm | 50 | – | 150 | 90 |

OUR CONFERENCE ROOMS

Minimum Sales

All consumed food and beverages count towards the guaranteed minimum sales. If the guaranteed minimum sales are not reached, we will charge the difference between the guaranteed and actual sales as room rent.

| Room | Up to 4 hours | up to 8 hours |
|--|---------------|---------------|
| Tagungsraum 1 oder 2 (Conference room 1 or 2) | € 400.00 | € 600.00 |
| Tagungsraum 1+2 (Conference room 1+2) | € 800.00 | € 1,200.00 |
| Heinzelmännchen | € 1,100.00 | € 1,600.00 |
| Roncalli | € 400.00 | € 600.00 |
| Kölner Raum (Cologne room) | € 400.00 | € 600.00 |
| Kaminraum (Fireplace room) | € 400.00 | € 600.00 |
| FRÜH Lounge | Upon request | |



If a room is used for over 8 hours, an additional room rent will be charged for every extra hour. Evening events are subject to other minimum sales guarantees. Please contact us for further information.

Technical equipment

All conference rooms have daylight. Note pads and pens are available free of charge.

Our offer for your technical equipment:

| | |
|-----------------------|---------|
| Projector and screen | € 40.00 |
| Flipchart | € 40.00 |
| Pinboard | € 40.00 |
| Facilitator's toolbox | € 40.00 |
| Speaker's desk | € 20.00 |

Additionally bookable in the FRÜH Lounge: Microphone € 35.00

Additionally bookable in the Conference room 1 + 2: Meeting technology* € 75.00

*85 inch display flatscreen with video camera, sound transmission & wireless presentation -also suitable for hybrid meetings.

If you need further equipment, please do not hesitate to contact us.

OUR CATERING SERVICES

Your individual snack break

Select four snacks for your individual break.

Savoury

Classic potato salad with mayonnaise, egg and gherkins, served in a small glass 🍴

Small meatball with gherkin

Small breaded pork escalope

Bruschetta "Cologne style" with raw minced pork spread, red onions, crème fraîche, au gratin with Gouda

Small meatloaf skewer with gherkin and mustard cream

Skewer of Dutch cheese 🍴

Mozzarella and cherry tomato skewer with "Cologne style" pesto 🍴

Vegetable sticks with herb dip 🍴

Bruschetta "Cologne style" with bell pepper and courgette 🍴

Bruschetta "Cologne style" with mashed beans 🍴

Sweets

Small chocolate croissant

Small croissant

Bircher muesli with grated apple, served in a small glass

Fruit yoghurt

Fruit skewer

Mixed chocolate bars

Fresh sheet cake, seasonal, different types



Price per person and snack break € 12.00

OUR CATERING SERVICES

Business lunch & buffet

For events up to 40 persons, you can select a 2-course meal from our brewhouse menu (€ 30.00 per person).

Alternatively, your guests can also have meals à la carte.

If your event has over 40 guests, we will gladly put an individual buffet together for you.

Please note that we offer a finger food snack buffet for 80 people or more.

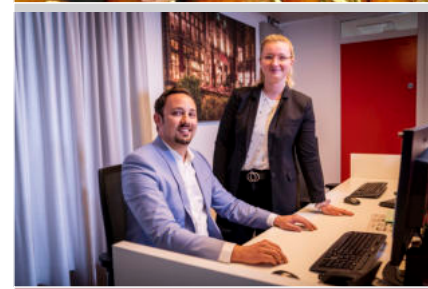

All-inclusive beverage package

The beverage package deal includes the following drinks for your event:

mineral water (carbonated and still), Coca-Cola, Coca-Cola zero, Fanta, apple spritzer, orange juice, apple juice, FRÜH Sport, coffee and various teas

Package deal for events lasting up to 8 hours € 29.00 / person

Package deal for events lasting up to 4 hours € 15.00 / person

If you would prefer other drinks, we will gladly send you our drinks menu.

All prices including VAT.

SUCCESSFUL MEETINGS

Apart from our conference rooms in the branch near the cathedral, we can also offer you further FRÜH branches in Cologne. For more details of the premises, capacities and sales, please contact us by telephone or e-mail.

früh **EM GOLDE KAPPES**

The city centre of Cologne is not the only place where you can enjoy the traditional Rhineland fare, freshly tapped Kölsch beer and hospitality of FRÜH Gastronomie. Our FRÜH „Em Golde Kappes“ in Cologne Nippes is an institution amongst the neighbourhood bars of Cologne. This traditional bar was established in 1913 by proprietor Matthias Becker from Nippes. Ever since then the inn that has always been known as the “Kneip op d’r Eck” (bar at the corner) has been an integral part of the district’s catering landscape. Locals from Nippes and people from many other Cologne neighbourhoods congregate here to enjoy their Kölsch beer together.

früh **EM VEEDEL**

The catering landscape of the “Severinsviertel” district is also formed by the FRÜH „Em Veedel“. We have been operating this traditional restaurant directly at “Chlodwigplatz” Square since 1979. The historic building is where the “A. Herrmann Distillery” used to have its restaurant. The restaurant serves traditional brewery fare with freshly tapped FRÜH Kölsch beer. The plain and rustic ambience invites guests to stay, get comfortable and party. Tradition-conscious as we are, this is still the place to go for schnapps from our own distillery, as used to be the case with the Herrmanns before.



früh **EM Jan von Werth**

The traditional „Jan von Werth“ inn joined the FRÜH family in September 2018. Be it hearty stews, thick Gouda slices on rye rolls, black pudding, or knuckle of pork - all dishes are freshly prepared to FRÜH’s proven recipes. Locals wash this down with a freshly tapped FRÜH Kölsch beer! For your lunch break, we are just as happy to serve you our alcohol-free FRÜH Sport soft drink. Only here: bowling is trendy and fun - why not book our rustic bowling alley?

früh **EM TATTERSALL**

A meeting place as ever, the Tattersall. Young and old from near and far like to meet here for a freshly tapped FRÜH Kölsch, even outside of racing days. The wonderful self-service beergarden with its old linden trees offers shelter from almost any weather. Families enjoy the traditional brewery cuisine and the spacious grounds far away from the traffic noise, in the middle of a landscape conservation area.